

Madison, Wisconsin

CITY OF MADISON

CITY ENGINEERING DIVISION

DEPARTMENT OF PUBLIC WORKS

PLAN OF PROPOSED IMPROVEMENT

PUBLIC IMPROVEMENT PROJECT APPROVED

FEBRUARY 6, 2018

BY THE COMMON COUNCIL OF MADISON, WISCONSIN

PUBLIC IMPROVEMENT DESIGN APPROVED BY:

[Signature] 2/23/18
City Engineer Date

INDEX OF SHEETS

SHEET NO.	TITLE
1	TITLE
D-1	DETAIL
EC1-EC2	EROSION CONTROL
P1-P2	PLAN & PROFILE
U1	SEWER PLAN & PROFILE
U2	SEWER SCHEDULES
PM1	PAVEMENT MARKING
E1	ELECTRICAL
X1-X5	CROSS SECTIONS

SOUTH LIVINGSTON STREET RECONSTRUCTION ASSESSMENT DISTRICT - 2018

CITY PROJECT NO. 11599
8103

CONSTRUCTION PROJECT LOCATION

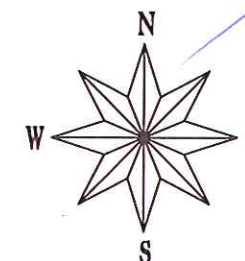

CONVENTIONAL SIGNS	
FIELD VERIFY ALL UTILITY LOCATIONS	
GAS	— G —
STORM SEWER	— ST —
SANITARY SEWER	— SAN —
WATER	— W —
OVERHEAD ELECTRIC	— OH —
POWER POLE	□
ADA COMPLIANT RAMP W/ DETECTABLE WARNING FIELD	▨

NOTES:
 ALL GUTTERS SHALL DRAIN WITH A MINIMUM GRADE OF 0.50% TOWARD STORM SEWER INLETS.
 SIDEWALK RAMPS AND CURB THRU SIDEWALK RAMPS SHALL HAVE A MAXIMUM SLOPE OF 1" PER 12". SIDEWALK AND CURB RAMPS SHALL BE CONSTRUCTED WITH A SIDE SLOPE OF 2.00%.
 SIDEWALK SHALL HAVE A MINIMUM LONGITUDINAL SLOPE OF 0.50% AND A MAXIMUM LONGITUDINAL SLOPE OF 5.00% EXCEPT WHERE STREET GRADES EXCEED 5.00%.

EARTH WORK SUMMARY:

EXCAVATION CUT (MEASURED PLAN QUANTITY)...	711.95 C.Y.
ESTIMATED UNDISTRIBUTED UNDERCUT.....	225.00 C.Y.
TOTAL UNCLASSIFIED EXCAVATION CUT.....	936.95 C.Y.

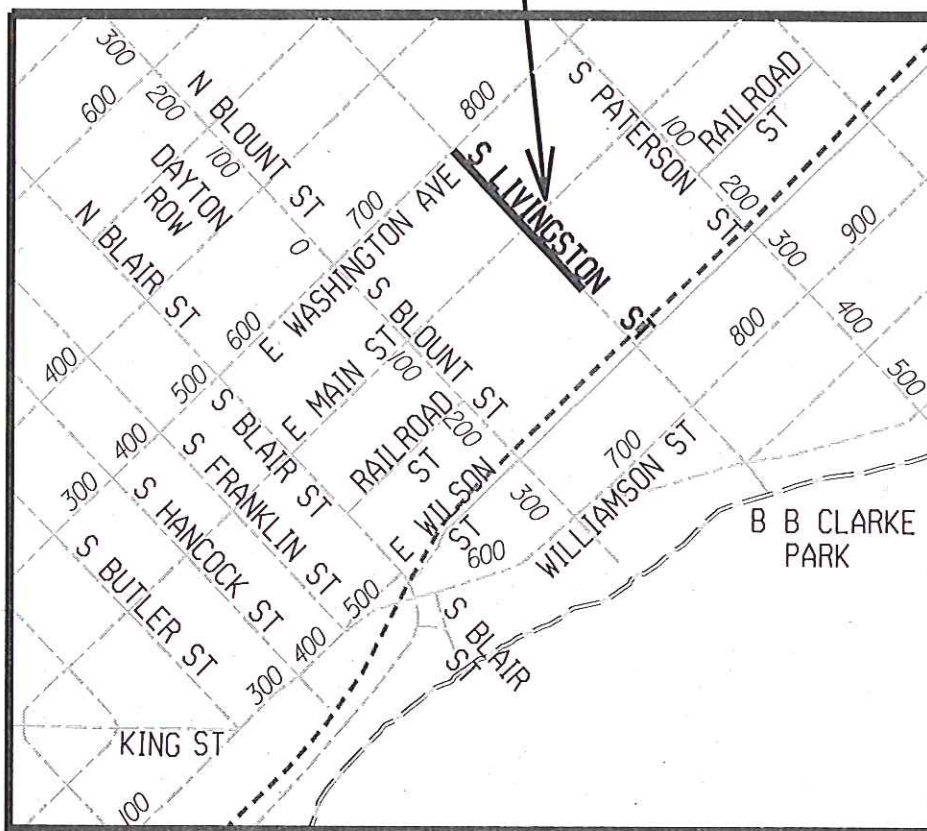

STREET DESIGNED BY:

 STEVEN M. SONNTAG
 E-38891
 MADISON, WI
 2/22/18
 PROFESSIONAL ENGINEER

SANITARY SEWER DESIGNED BY:

 MARK D. MOYER
 E-33978
 MADISON, WI
 2/22/18
 PROFESSIONAL ENGINEER

STORM SEWER DESIGNED BY:

 GREGORY E. ...
 E-20656
 MADISON, WI
 2/23/18
 PROFESSIONAL ENGINEER

PLOT SCALE:

PLOT NAME:

REV. DATE:

ORIGINATOR: CITY OF MADISON, STREETS DIVISION

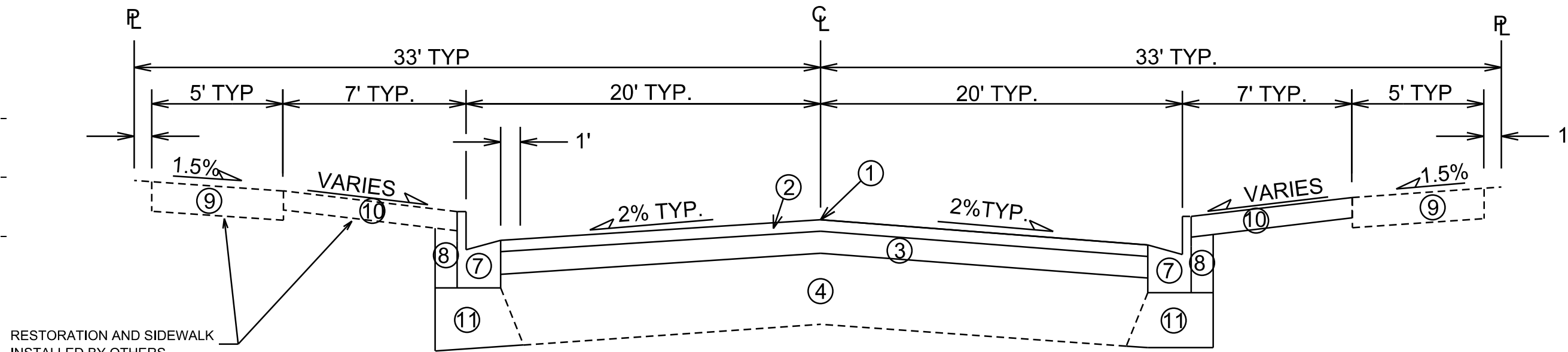

TYPICAL SECTION
SOUTH LIVINGSTON STREET
STA. 119+00 TO STA. 121+75

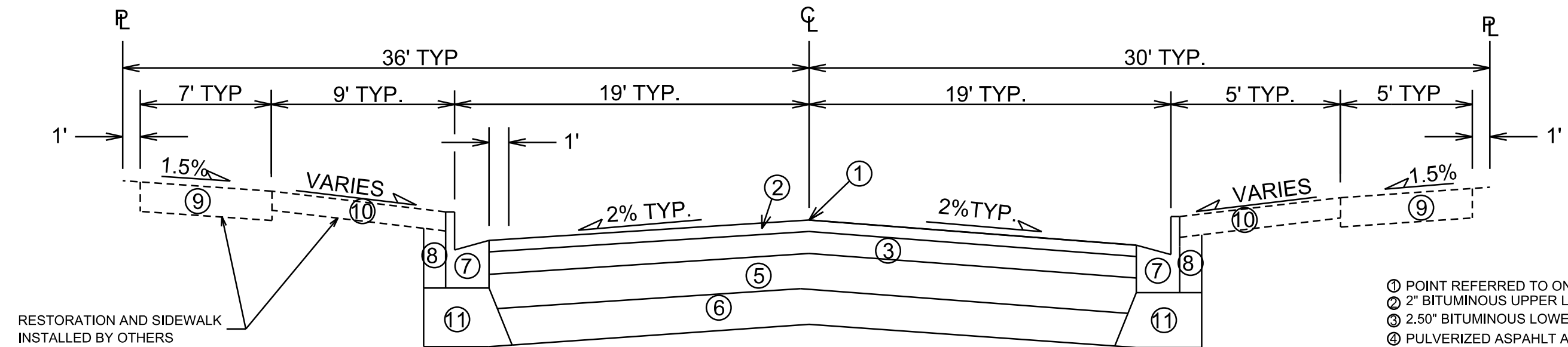

TYPICAL SECTION
SOUTH LIVINGSTON STREET
STA 122+50 TO STA 126+00

- ① POINT REFERRED TO ON PROFILE
- ② 2" BITUMINOUS UPPER LAYER, 4 LT 58-28 S
- ③ 2.50" BITUMINOUS LOWER LAYER, 3 LT 58-28 S
- ④ PULVERIZED ASPHALT AND EXISTING BASE
- ⑤ 6" GRADATION 2 CRUSHED STONE
- ⑥ 6" GRADATION 1 CRUSHED STONE
- ⑦ REMOVE & REPLACE CONCRETE CURB & GUTTER AS SHOWN ON THE PLAN OR AS DIRECTED BY THE ENGINEER
- ⑧ FILL, INCIDENTAL WHERE CURB IS REPLACED
- ⑨ 5" CONCRETE SIDEWALK, REMOVE & REPLACE AS SHOWN ON THE PLAN OR AS DIRECTED BY THE ENGINEER
- ⑩ RESTORE DISTURBED AREAS W/ 4" TOPSOIL, SEED & MAT
- ⑪ 4" MIN GRADATION 2 CRUSHED AGGREGATE AS NECESSARY FOR CURB REPLACEMENT

RESTORATION AND SIDEWALK
INSTALLED BY OTHERS

RESTORATION AND SIDEWALK
INSTALLED BY OTHERS

* SEE CROSS SECTION SHEETS FOR CROSS SLOPES AND TOP OF CURB ELEVATIONS.





TYPICAL SECTION NOT TO SCALE

SEWER
PLAN AND PROFILE
SOUTH LIVINGSTON STREET CITY OF MADISON

EROSION CONTROL NOTES:
EROSION CONTROL MEASURES SHALL BE IN PLACE PRIOR TO ANY OTHER CONSTRUCTION ACTIVITY.
THE CONTRACTOR IS RESPONSIBLE FOR THE CONSTRUCTION AND MAINTENANCE OF ALL EROSION CONTROL MEASURES UNTIL FINAL ACCEPTANCE BY THE CITY OF MADISON.
THE CONTRACTOR SHALL INSTALL AND MAINTAIN EROSION CONTROL MEASURES IN ACCORDANCE WITH THE WDRSOC STANDARDS AND CITY OF MADISON STANDARD SPECIFICATIONS.
THE CONTRACTOR SHALL PROVIDE STREET CLEANING AS NEEDED ON A DAILY BASIS TO KEEP TRACKING TO A MINIMUM.
INLET PROTECTION SHALL BE INSTALLED WITHIN THE CONSTRUCTION LIMITS. ADDITIONAL INLET PROTECTION SHALL BE INSTALLED AS DIRECTED.
DEWATERING MUST FILTER WATER PRIOR TO DISCHARGE. DEWATERING DISCHARGE MUST BE TO STABILIZED GROUND.

0709-134-1015-9
GEBHARDT FRANK CONDO OWNERS ASSOC INC
803 E Washington Ave #CDM

0709-133-0306-5
MADISON GAS & ELECTRIC
JIM MONTGOMERY
722 E Main St

-  STREET CONSTRUCTION ENTRANCE BERM
-  CONSTRUCTION ENTRANCE
-  TYPE D HYBRID INLET PROTECTION
-  TYPE C INLET PROTECTION

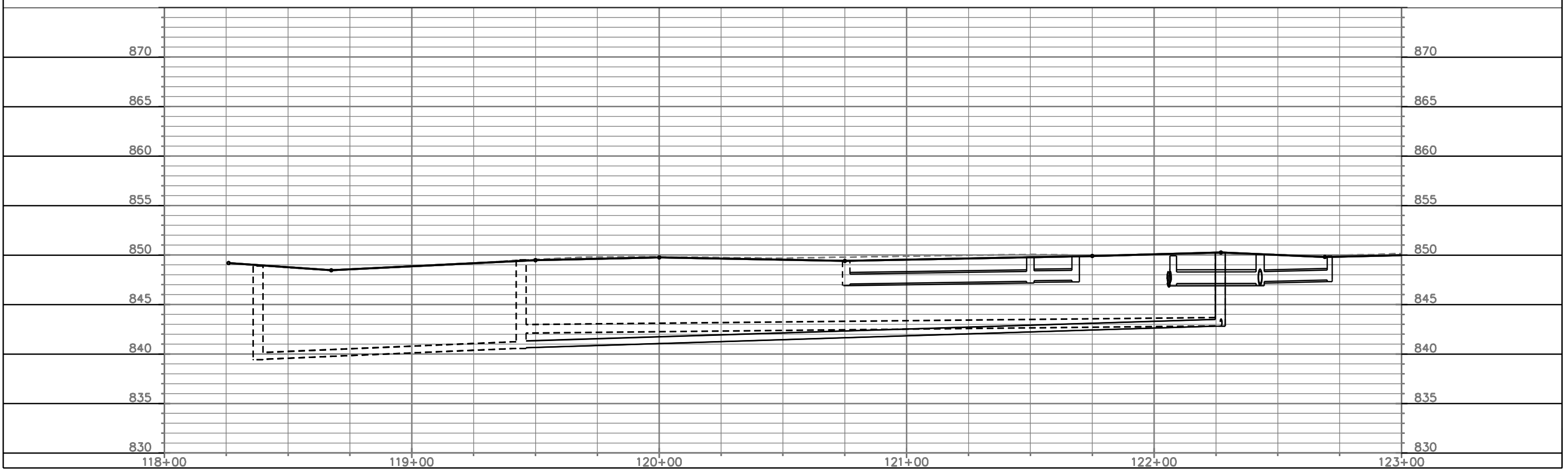
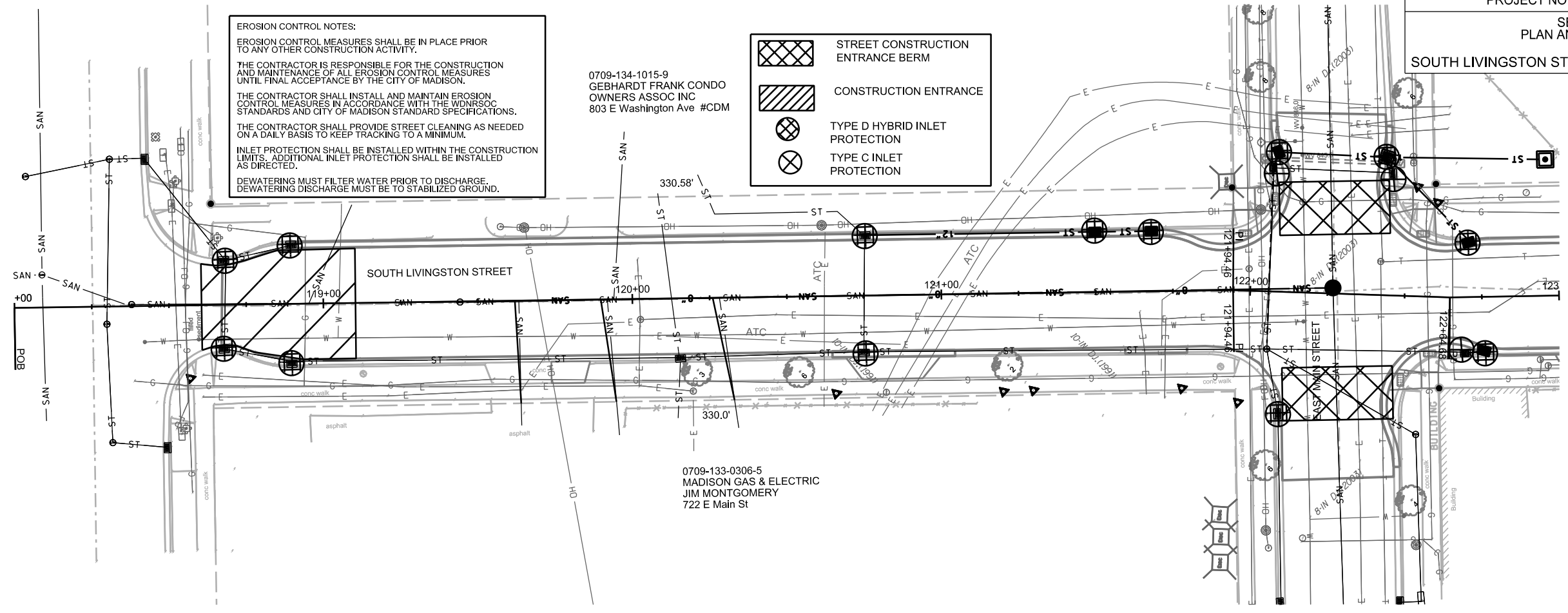





PLOT SCALE: _____

PLOT NAME: _____

REV. DATE: _____

ORIGINATOR: CITY OF MADISON, STREETS DIVISION

PLAN AND PROFILE
SOUTH LIVINGSTON STREET CITY OF MADISON

-  STREET CONSTRUCTION ENTRANCE BERM
-  CONSTRUCTION ENTRANCE
-  TYPE D HYBRID INLET PROTECTION
-  TYPE C INLET PROTECTION

EROSION CONTROL NOTES:
 EROSION CONTROL MEASURES SHALL BE IN PLACE PRIOR TO ANY OTHER CONSTRUCTION ACTIVITY.
 THE CONTRACTOR IS RESPONSIBLE FOR THE CONSTRUCTION AND MAINTENANCE OF ALL EROSION CONTROL MEASURES UNTIL FINAL ACCEPTANCE BY THE CITY OF MADISON.
 THE CONTRACTOR SHALL INSTALL AND MAINTAIN EROSION CONTROL MEASURES IN ACCORDANCE WITH THE WDNR/SOC STANDARDS AND CITY OF MADISON STANDARD SPECIFICATIONS.
 THE CONTRACTOR SHALL PROVIDE STREET CLEANING AS NEEDED ON A DAILY BASIS TO KEEP TRACKING TO A MINIMUM.
 INLET PROTECTION SHALL BE INSTALLED WITHIN THE CONSTRUCTION LIMITS. ADDITIONAL INLET PROTECTION SHALL BE INSTALLED AS DIRECTED.
 DEWATERING MUST FILTER WATER PRIOR TO DISCHARGE. DEWATERING DISCHARGE MUST BE TO STABILIZED GROUND.

0709-134-1203-0
CITY OF MADISON
111 S Livingston St

0709-134-1202-2
MADISON GAS & ELECTRIC
% JIM MONTGOMERY
211 S Livingston St

0709-133-0401-3
MADISON GAS & ELECTRIC
% JIM MONTGOMERY
717 E Main St

0709-134-1802-0
MADISON GAS & ELECTRIC
% JIM MONTGOMERY
201 S Blount St

MATCHLINE STA 123+00.00

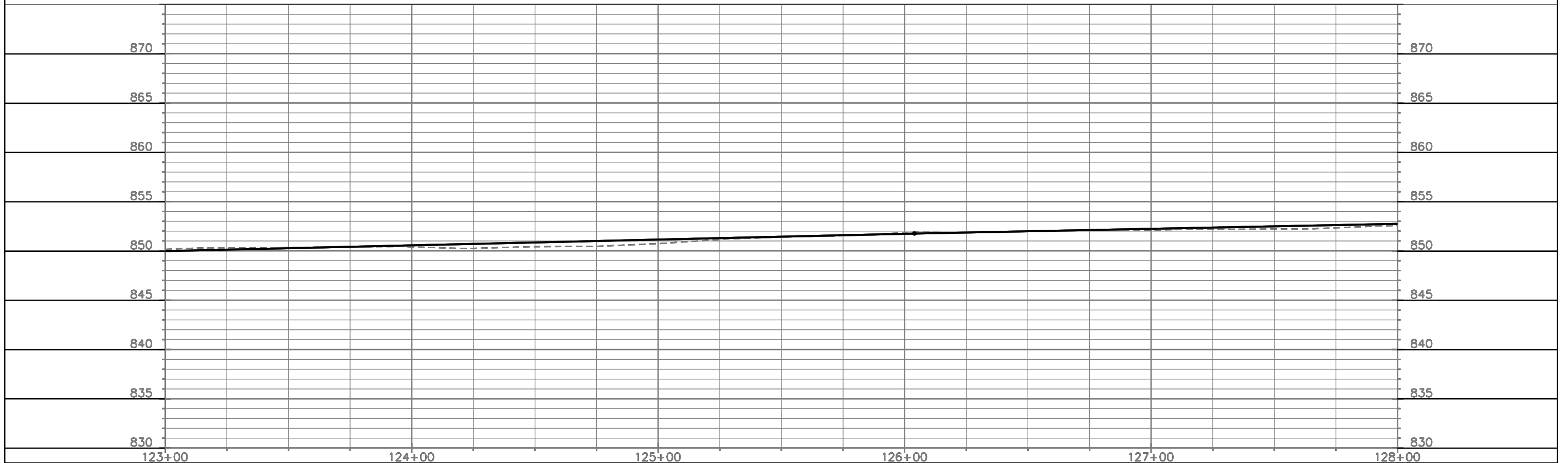
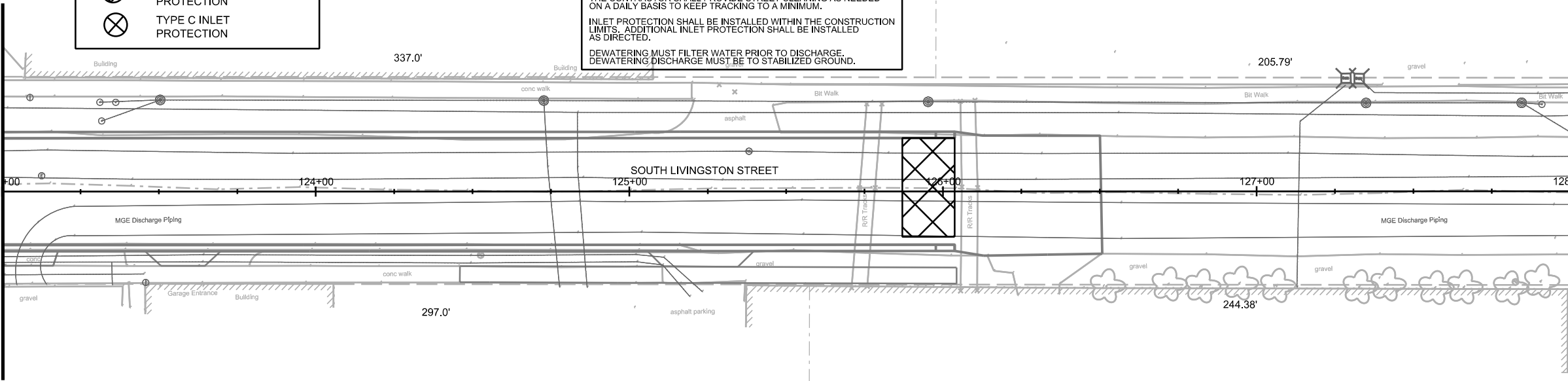

PLOT SCALE: _____

PLOT NAME: _____

REV. DATE: _____

ORIGINATOR: CITY OF MADISON, STREETS DIVISION

0709-134-1015-9
 GEBHARDT FRANK CONDO OWNERS ASSOC INC
 803 E Washington Ave #CDM

0709-133-0306-5
 MADISON GAS & ELECTRIC JIM MONTGOMERY
 722 E Main St

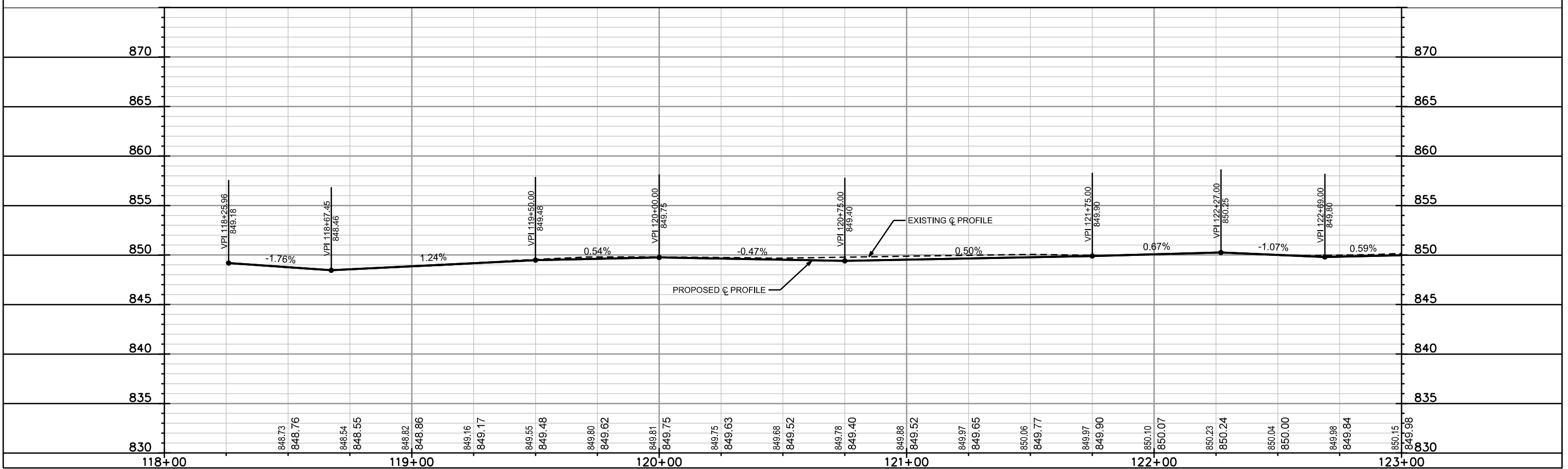
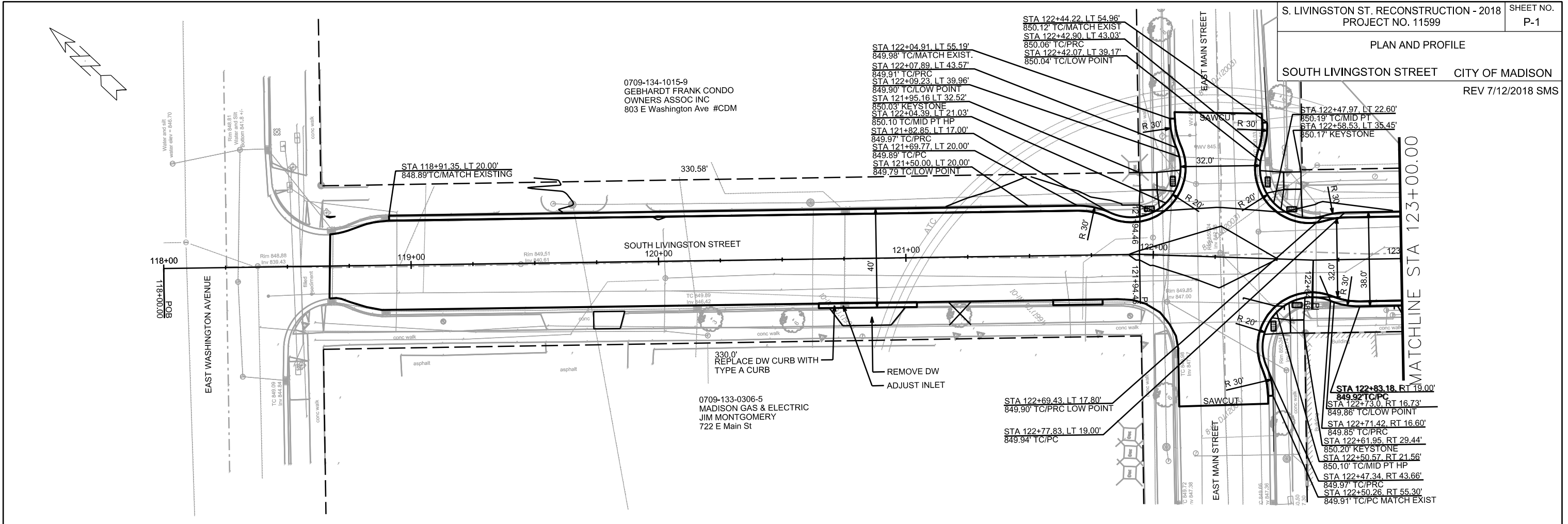

PLOT SCALE: _____

PLOT NAME: _____

REV. DATE: _____

ORIGINATOR: CITY OF MADISON, STREETS DIVISION

PLAN AND PROFILE SOUTH LIVINGSTON STREET CITY OF MADISON

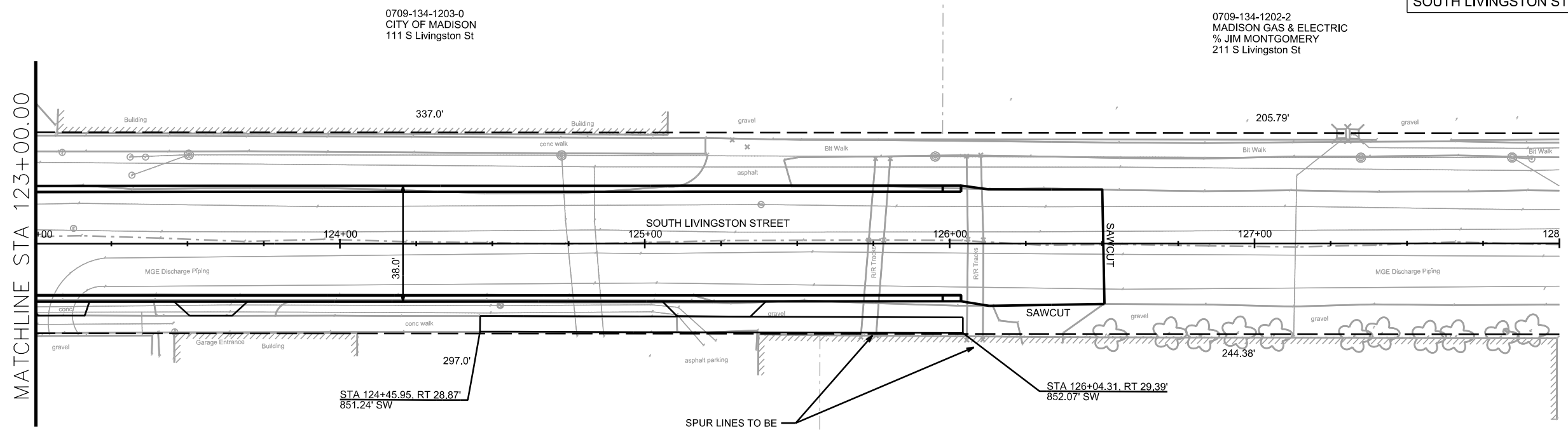
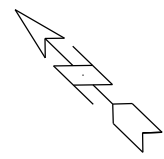

0709-134-1203-0
CITY OF MADISON
111 S Livingston St

0709-134-1202-2
MADISON GAS & ELECTRIC
% JIM MONTGOMERY
211 S Livingston St

0709-133-0401-3
MADISON GAS & ELECTRIC
% JIM MONTGOMERY
717 E Main St

0709-134-1802-0
MADISON GAS & ELECTRIC
% JIM MONTGOMERY
201 S Blount St

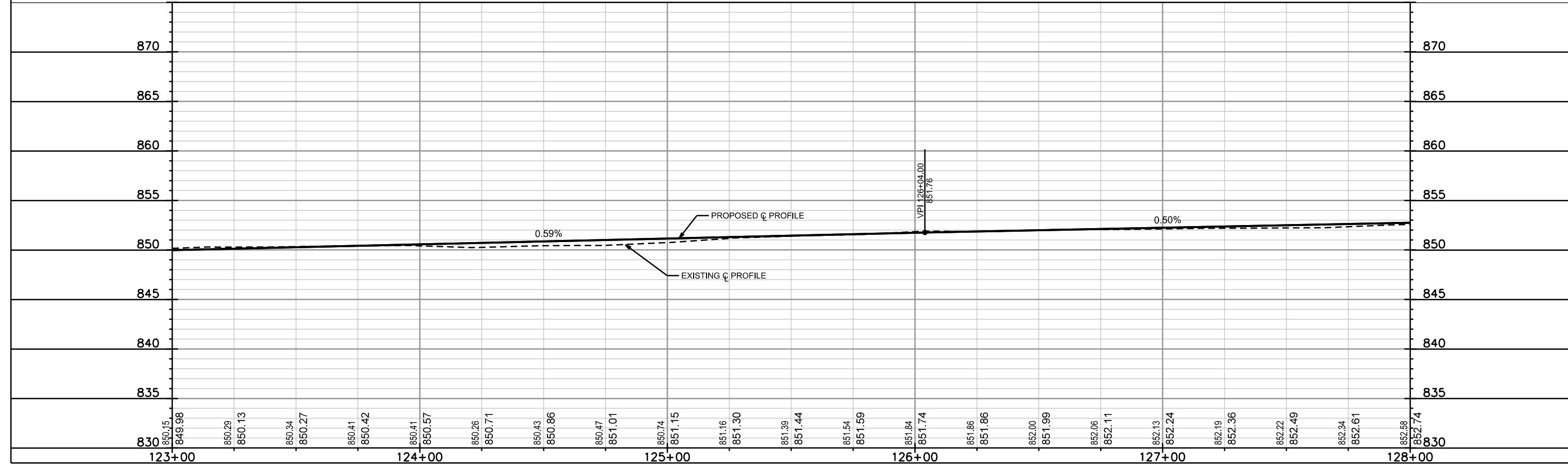

PLOT SCALE: _____

PLOT NAME: _____

REV. DATE: _____

ORIGINATOR: CITY OF MADISON, STREETS DIVISION

SEWER
PLAN AND PROFILE

SOUTH LIVINGSTON STREET CITY OF MADISON

REV 3/26/2018 DAO
REV 7/12/2018 DAO

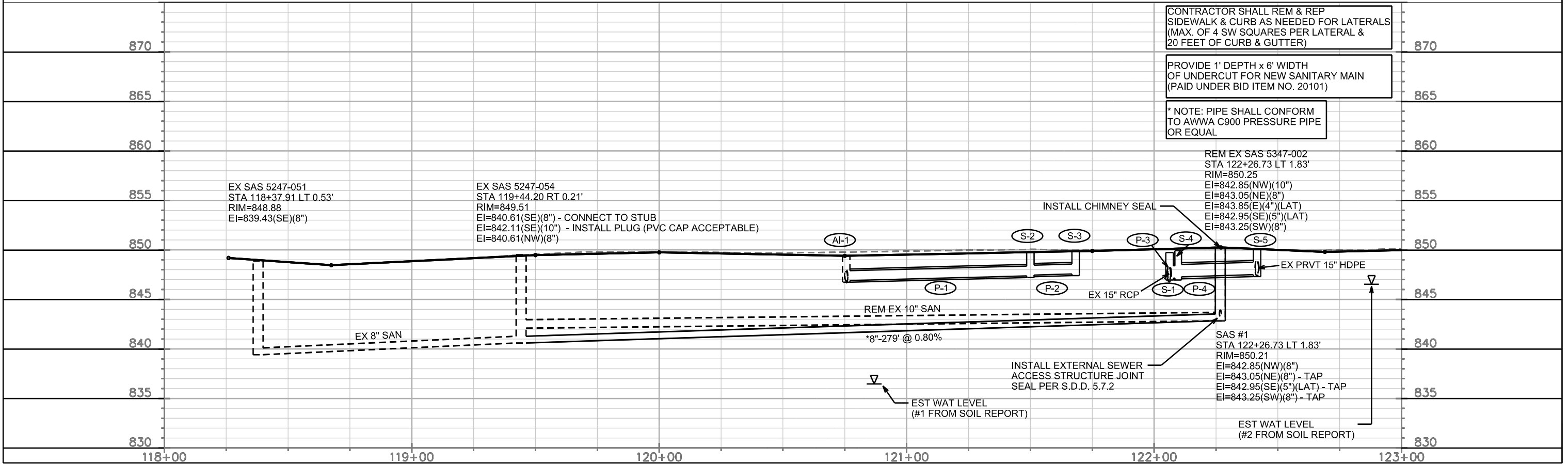
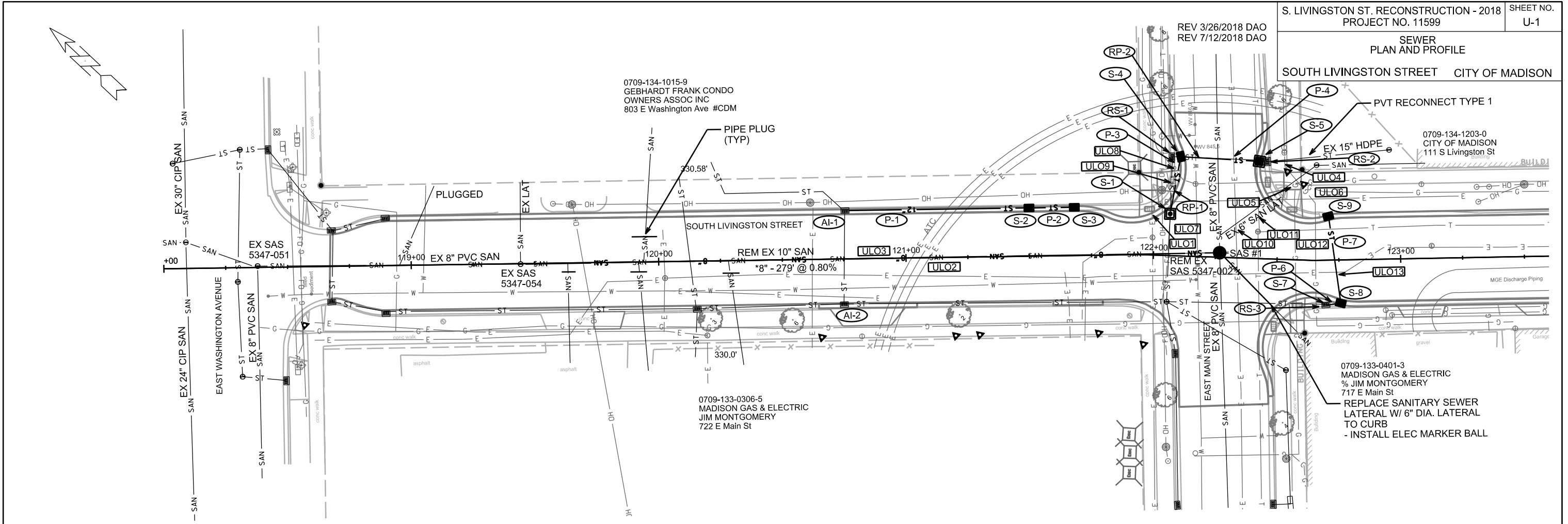

CONTRACTOR SHALL REM & REP
SIDEWALK & CURB AS NEEDED FOR LATERALS
(MAX. OF 4 SW SQUARES PER LATERAL &
20 FEET OF CURB & GUTTER)

PROVIDE 1' DEPTH x 6' WIDTH
OF UNDERCUT FOR NEW SANITARY MAIN
(PAID UNDER BID ITEM NO. 20101)

* NOTE: PIPE SHALL CONFORM
TO AWWA C900 PRESSURE PIPE
OR EQUAL

REM EX SAS 5347-002
STA 122+26.73 LT 1.83'
RIM=850.25
EI=842.85(NW)(10")
EI=843.05(NE)(8")
EI=843.85(E)(4")(LAT)
EI=842.95(SE)(5")(LAT)
EI=843.25(SW)(8")

SAS #1
STA 122+26.73 LT 1.83'
RIM=850.21
EI=842.85(NW)(8")
EI=843.05(NE)(8") - TAP
EI=842.95(SE)(5")(LAT) - TAP
EI=843.25(SW)(8") - TAP

PLOT SCALE: _____

REV. DATE: _____

ORIGINATOR: CITY OF MADISON, STREETS DIVISION

SANITARY & STORM SEWER SCHEDULE

* REV 3/26/2018 DAO
 ** REV 7/12/2018 DAO

S. LIVINGSTON ST. RECONSTRUCTION - 2018	SHEET NO.
PROJECT NO. 11599	U-2
SEWER SCHEDULE	
CITY OF MADISON	

PROPOSED SANITARY STRUCTURES

SAS NO.	STATION	LOCATION (OFFSET)	TOP OF CASTING	E.I.	DEPTH	NOTES
SAS #1	122+26.73	LT-1.82	850.21	842.85	7.36	(2)(3)

REMOVE SANITARY STRUCTURES

SAS NO.	STATION	LOCATION (OFFSET)	TOP OF CASTING	E.I.	DEPTH	NOTES
SAS 5347-002	122+26.73	LT-1.83	850.25	842.85	7.40	

PROPOSED STORM STRUCTURES

STRUC. NO.	STATION	LOCATION (OFFSET)	TYPE	TOP OF CASTING	E.I.	DEPTH	NOTES
** S-1	122+06.24	RT-16.87	3x3 SAS	849.74	847.11	2.63	FP; w/ R-1550-0054
** S-2	121+50.00	LT-19.50	H Inlet	849.79	847.39	2.40	LP;FP; w/ R-3067-7004-VB
** S-3	121+68.28	LT-19.50	H Inlet	849.89	847.59	2.30	FP; w/ R-3067-7004-V
** S-4	122+09.71	LT-40.09	H Inlet	849.92	847.18	2.74	LP;FP; w/ R-3067-7004-VB
** S-5	122+41.58	LT-39.23	3x3 SAS	850.04	847.52	2.52	LP;FP; w/ R-3067-7004-VB (1)
S-6							
S-7	122+69.41	RT-18.18	Collar	-	847.61	-	
S-8	122+75.48	RT-17.48	H Inlet	849.86	847.61	2.25	LP;FP; w/ R-3067-7004-VB
** S-9	122+70.99	LT-17.70	H Inlet	849.90	847.65	2.25	LP;FP; w/ R-3067-7004-VB

REMOVE STORM STRUCTURES

STRUC. NO.	ID NO.	STATION	LOCATION (OFFSET)	TYPE	NOTES
RS-1	IN 5347-067	122+06.43	LT-40.01	INLET	
RS-2	IN 5347-068	122+43.93	LT-39.40	INLET	
RS-3	IN 5347-065	122+69.42	RT-18.18	INLET	

STORM SEWER ULOs

ULO NO.	STATION	LOCATION (OFFSET)	TYPE	NOTES
** ULO1	121+98.89	LT-17.12	ELEC	TOP @ 847.31, BOT @ 844.71 (3' WIDE)
ULO2	121+04.12	RT-0.26	ATC ELEC	
** ULO3	121+02.2	LT-5.00	ATC ELEC	TOP @ 840.83 (8" STEEL)
** ULO4	122+51.85	LT-38.47	GAS	TOP @ 847.33 (12" STEEL)
** ULO5	122+56.41	LT-31.00	GAS	TOP @ 847.72 (10" STEEL)
** ULO6	122+65.88	LT-23.13	ELEC	TOP @ 844.54 (2X3" PVC)
** ULO7	122+06.24	RT-16.87	FO	TOP @ 847.51 (3" PVC)
** ULO8	122+08.85	LT-35.69	GAS	TOP @ 844.17 (12" STEEL)
** ULO9	122+06.64	LT-29.12	TEL	TOP @ 847.14 (4" PVC)
** ULO10	122+33.00	LT-11.59	ELEC	TOP @ 848.47 (PROVIDED BY TERRA)
** ULO11	122+42.04	LT-8.01	FO	TOP @ 847.59 (PROVIDED BY TERRA)
** ULO12	122+56.83	LT-11.80	FO/GAS	TOP @ 846.94 (12" STEEL GAS) TOP @ 845.51 (COMM DUCT)
** ULO 13	122+74.00	RT-4.96	ELEC	MG&E ESTIMATES TOP @ 8' BELOW SURFACE

SPECIFIC NOTES

- (1) TAP & RECONNECT 15" STORM FROM 111 S LIVINGSTON (PAID PER BID ITEM 50793)
- (2) EXTERNAL SEWER ACCESS STRUCTURE JOINT SEAL (PAID UNDER BID ITEM 50797)
- (3) INSTALL INTERNAL CHIMNEY SEAL (PAID UNDER BID ITEM 50771)

PROPOSED SANITARY PIPES

FROM (DNSTM)	TO (UPSTM)	DWNSTRM E.I.	UPSTRM E.I.	PLAN (PAY) LGTH (FT)	SLOPE (%)	PIPE SIZE	PVC TYPE	NOTES
SAS 5247-054	SAS #1	840.61	842.85	279.00	0.80%	8"	SDR-35	STUB PROVIDED AT SAS 5247-054

REMOVE SANITARY PIPES

FROM (DNSTM)	TO (UPSTM)	LGTH (FT)	PAID (Y/N)	PAY AMOUNT	SIZE	PIPE TYPE	NOTES
SAS 5247-054	SAS 5347-002	279.00	N	0.00	10"	EX. SAN VP	PLUG PIPE AT SAS 5247-054

PROPOSED STORM PIPES

PIPE NO.	FROM (DNSTM)	TO (UPSTM)	DISCH. E.I.	INLET E.I.	PLAN (PAY) LGTH (FT)	PIPE LGTH (FT)	SLOPE (%)	PIPE SIZE	TYPE	NOTES
** P-1	AI-1	S-2	846.89	847.39	74.5	71.5	0.70%	12"	TYPE II STORM	
** P-2	S-2	S-3	847.44	847.59	18.0	15	1.00%	12"	TYPE II STORM	
** P-3	S-1	S-4	847.11	847.18	23.5	20	0.35%	15"	TYPE II STORM	
** P-4	S-4	S-5	847.23	847.52	32.0	30	0.97%	15"	RCP	
P-5										
P-6	S-7	S-8	847.61	847.61	6.0	4.5	0.00%	12"	RCP	
** P-7	S-8	S-9	847.61	847.65	34.5	33	0.12%	12"	TYPE II STORM	

REMOVE STORM PIPES

REMOVE NO.	REMOVE FROM	REMOVE TO	LGTH (FT)	PIPE SIZE	PIPE TYPE	PAID (Y/N)	NOTES
* RP-1	S-1	RS-1	23.00	15.00	RCP	N	
* RP-2	RS-1	RS-2	38.50	12.00	RCP	Y	

STORM STRUCTURE ADJUSTMENTS

ADJUST NO.	STATION	LOCATION (OFFSET)	EX. TOC ELEV.	ADJUST ELEV.	ADJUST DIFF.	NOTES
AI-1	120+75.58	LT-19.50	849.44	850.00	0.56	
AI-2	120+74.83	RT-18.52	849.12	849.58	0.46	

NOTE: PLAN LENGTH (PAY LENGTH) IS FROM CENTER OF STRUCTURE TO CENTER OF STRUCTURE. PIPE LENGTH IS ACTUAL LENGTH OF PIPE FROM STRUCTURE WALL TO STRUCTURE WALL. SLOPE CALCULATED USING PIPE LENGTH.

STANDARD NOTES:

- ABBREVIATIONS: AE = APRON ENDWALL; RCP = REINFORCED CONCRETE PIPE; HERCP = HORIZONTAL ELLIPTICAL REINFORCED CONCRETE PIPE; DNA = DOES NOT APPLY; SAS = SEWER ACCESS STRUCTURE; LP = LOW POINT INLET STRUCTURE; FP = FIELD POURED STRUCTURE; TR = TOP OF CONCRETE ROOF; NCM = NO CROWN MATCH FOR PIPES; UD = UNDERDRAIN
- APPROXIMATE DISCHARGE E.I. GIVEN, ADJUST E.I. AND PIPE SLOPE IN THE FIELD.
- TOP OF CASTING GRADE GIVEN IS THE TOP OF CURB FOR INLET STRUCTURES AND THE FLOWLINE OF THE CLOSED CASTING FOR SAS's.
- TOP OF CONCRETE ROOF (TR) IS 1.25' BELOW TOP OF CASTING UNLESS OTHERWISE NOTED.
- ALL REINFORCED CONCRETE PIPES TO BE CLASS III UNLESS OTHERWISE NOTED.
- SURVEYOR TO CONFIRM THAT ALL INLET STATION / OFFSETS LINE UP WITH PROPOSED CURB AND GUTTER.
- ALL STRUCTURES CALLED OUT AS FIELD POURED SHALL BE FIELD POURED. ALL OTHER STRUCTURES (NOT INDICATED AS FIELD POURED) SHALL BE SUBMITTED TO CITY ENGINEERING FOR APPROVAL IF PRECAST STRUCTURES ARE PREFERRED. CONTACT DANIEL OLIVARES OF CITY ENGINEERING AT (608) 261-9285 FOR PRECAST APPROVALS, FAX SHOP DRAWINGS TO (608)264-9275, OR EMAIL SHOP DRAWINGS TO DAOLIVARES@CITYOFMADISON.COM.

Pavement Marking Plan

CITY OF MADISON

Callout	Description
1	Pavement Marking Epoxy, Stop Line, 24-Inch
2	Pavement Marking Epoxy, Line, 6-Inch Yellow (10X30)
3	Pavement Marking Epoxy, Crosswalk, 6-Inch
4	Pavement Marking Epoxy, Double Line, 4-Inch Solid Yellow



PLOT SCALE:

PLOT NAME:

REV. DATE:

ORIGINATOR: CITY OF MADISON, TRAFFIC ENG. DIV.

803

111

722

717

E. Main Street

S. Livingston Street

S. Livingston Street

100'

6'

6'

6'

6'

1

2

3

3

3

1

4

1

3

Electrical Plan

CITY OF MADISON



803

E. Main Street

1. THE CONTRACTOR SHALL DO ALL WORK IN ACCORDANCE WITH CITY OF MADISON STANDARD SPECIFICATIONS FOR PUBLIC WORKS CONSTRUCTION 2018 EDITION AND ALL ADDENDUMS THERETO. ALL CONDUIT SHALL BE PVC SCHEDULE 80 UNDER PAVEMENT OR SCHEDULE 40 OTHERWISE. PULL WIRE REQUIRED AS PER STANDARD SPECIFICATIONS.
2. THE CONTRACTOR SHALL CALL MIKE BENZSCHAWEL (266-4767) AT THE TRAFFIC ENGINEERING SHOP AT LEAST 24-HOURS IN ADVANCE OF BURYING CONDUIT TO ARRANGE FOR INSPECTION.
3. THE CONTRACTOR SHALL STUB CONDUIT IF HANDHOLES NOT IN PLACE DURING CONSTRUCTION

INSTALL 1-INCH SCH 80 PVC CONDUIT

TYPE-1 HANDHOLE TO BE INSTALLED BY OTHERS

INSTALL 3-INCH SCH 80 PVC CONDUIT

TYPE-5 HANDHOLE TO BE INSTALLED BY OTHERS

111

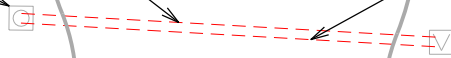

S. Livingston Street

S. Livingston Street

722

717

PLOT SCALE:

PLOT NAME:

REV. DATE:

ORIGINATOR: CITY OF MADISON, TRAFFIC ENG. DIV.

SIDEWALK SHOWN FOR
REFERENCE ONLY
INSTALLED BY OTHERS

PLOT SCALE: _____

PLOT NAME: _____

REV. DATE: _____

ORIGINATOR: CITY OF MADISON, STREETS DIVISION

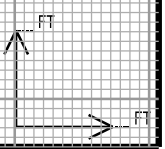
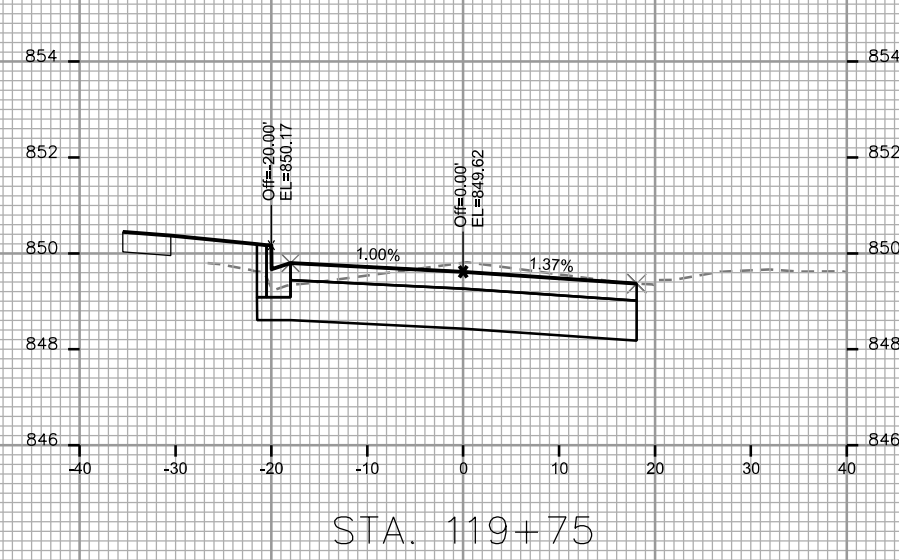
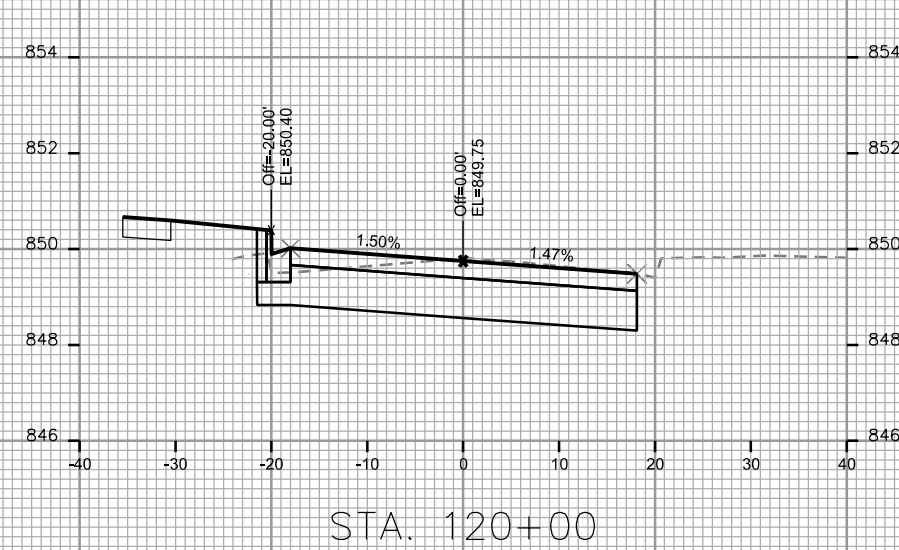
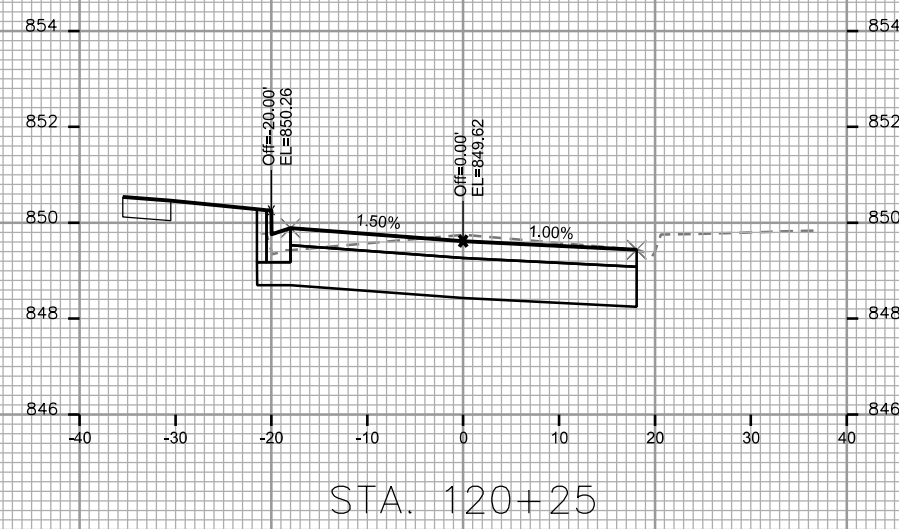
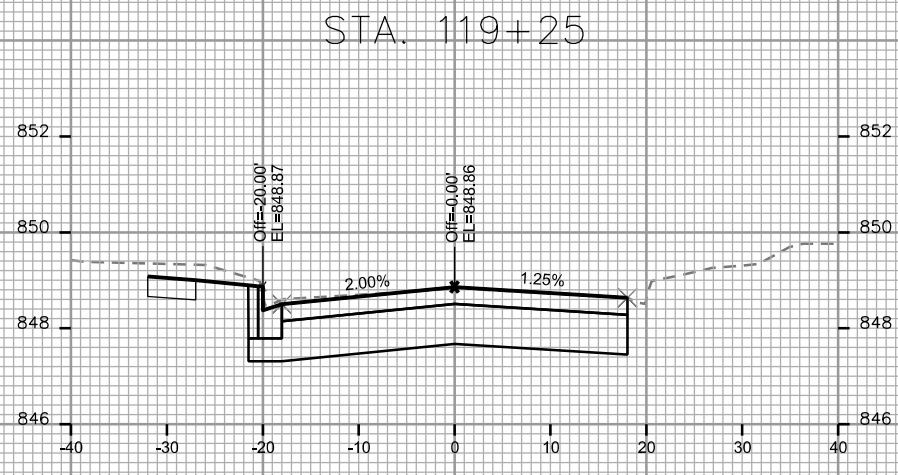
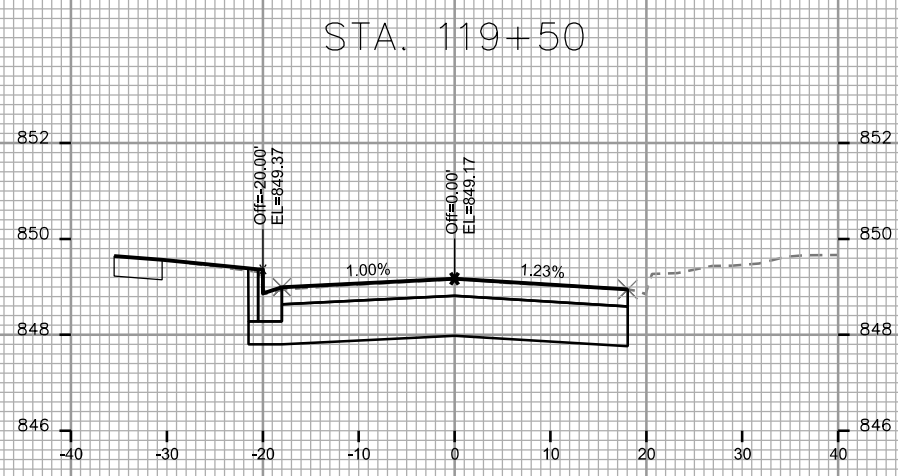

SIDEWALK SHOWN FOR
REFERENCE ONLY
INSTALLED BY OTHERS

PLOT SCALE: _____

PLOT NAME: _____

REV. DATE: _____

ORIGINATOR: CITY OF MADISON, STREETS DIVISION

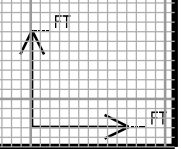
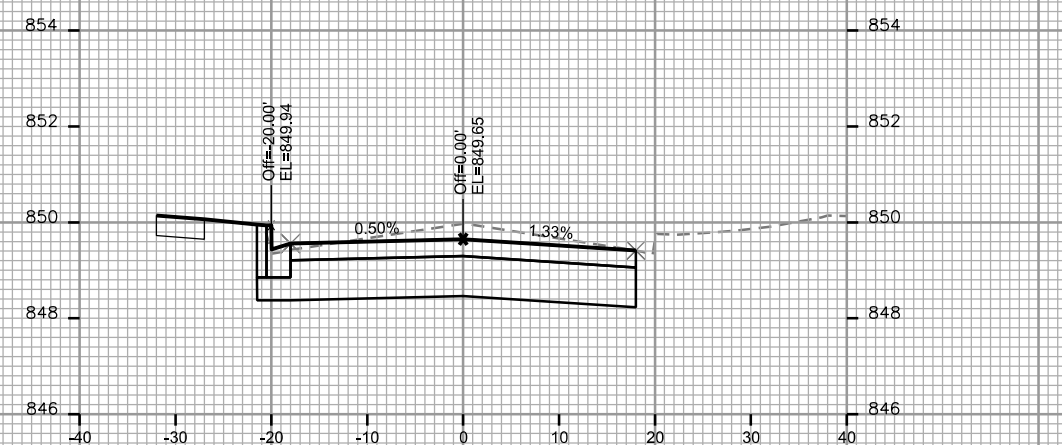
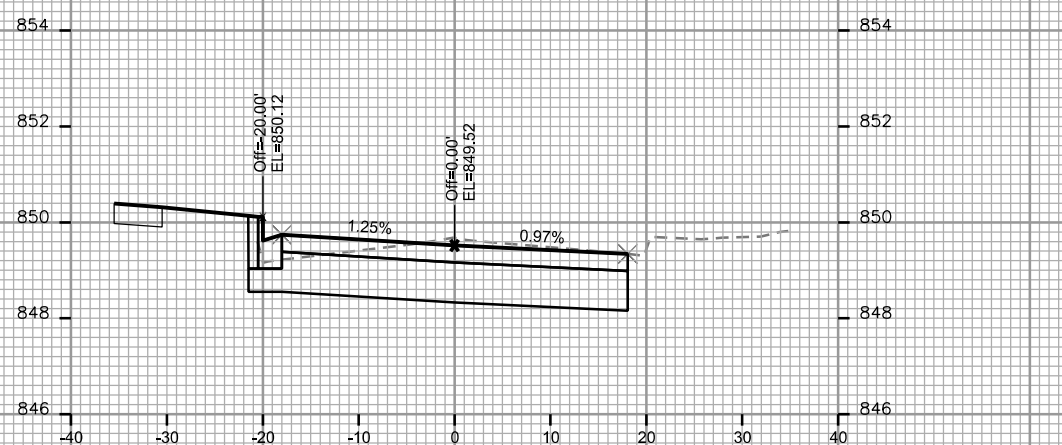
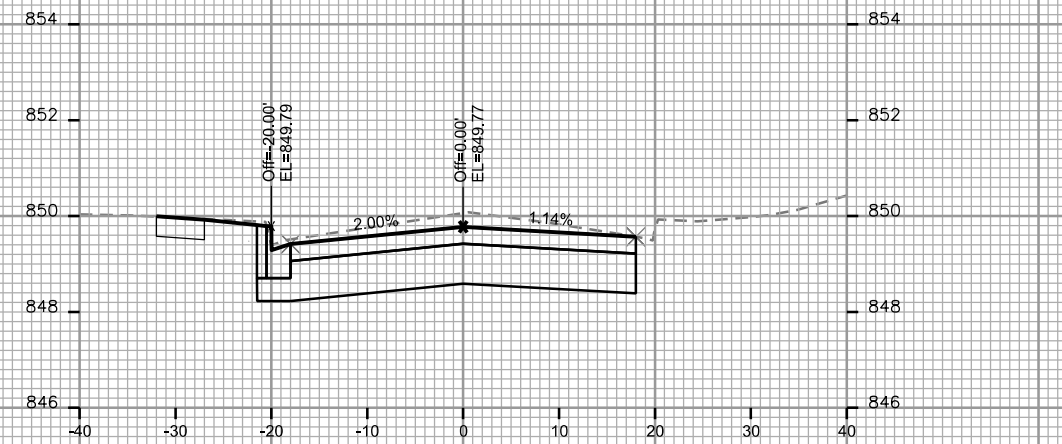
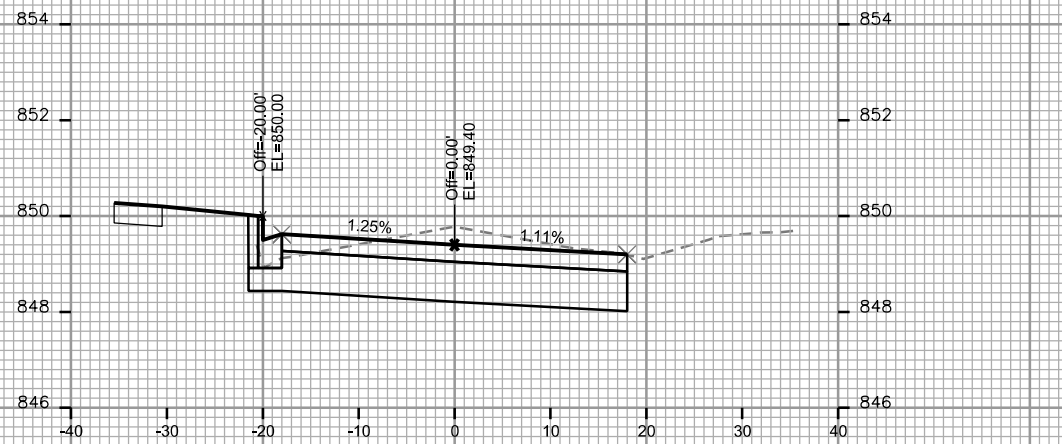
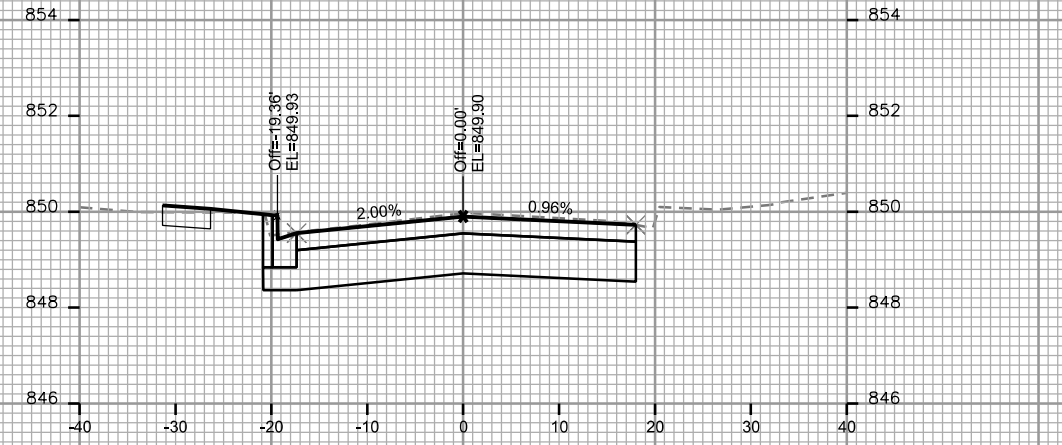
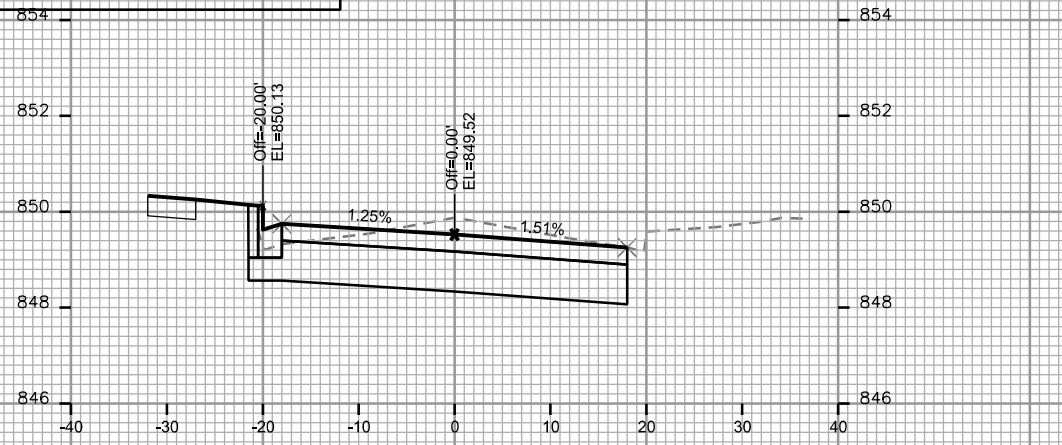

SIDEWALK SHOWN FOR
REFERENCE ONLY
INSTALLED BY OTHERS

CROSS SECTIONS

SOUTH LIVINGSTON STREET CITY OF MADISON

PLOT SCALE: _____

PLOT NAME: _____

REV. DATE: _____

ORIGINATOR: CITY OF MADISON, STREETS DIVISION

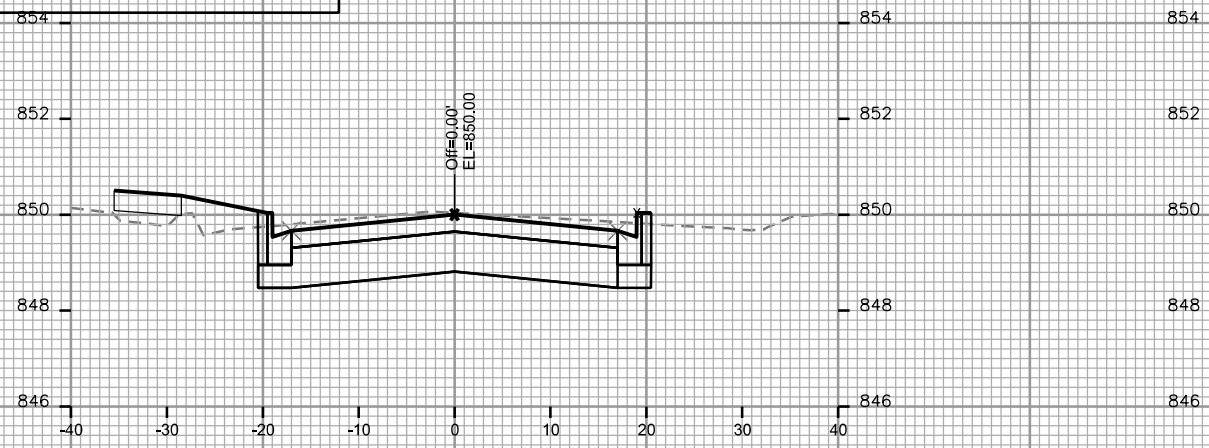

STA. 122+50

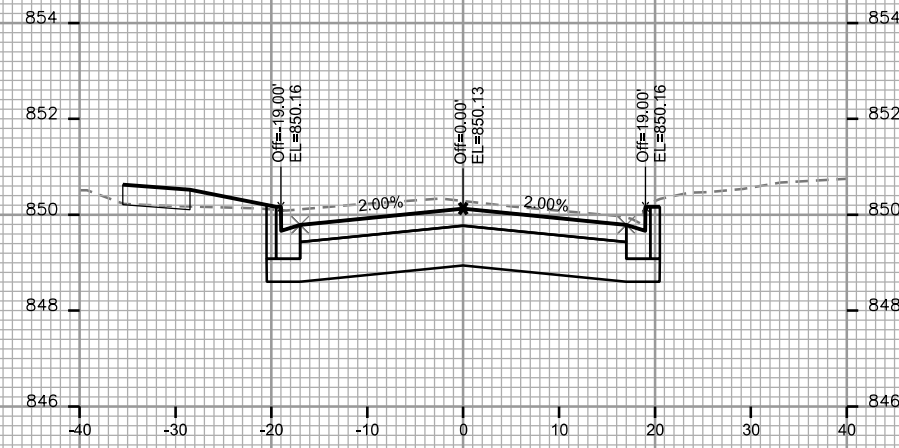

STA. 123+25

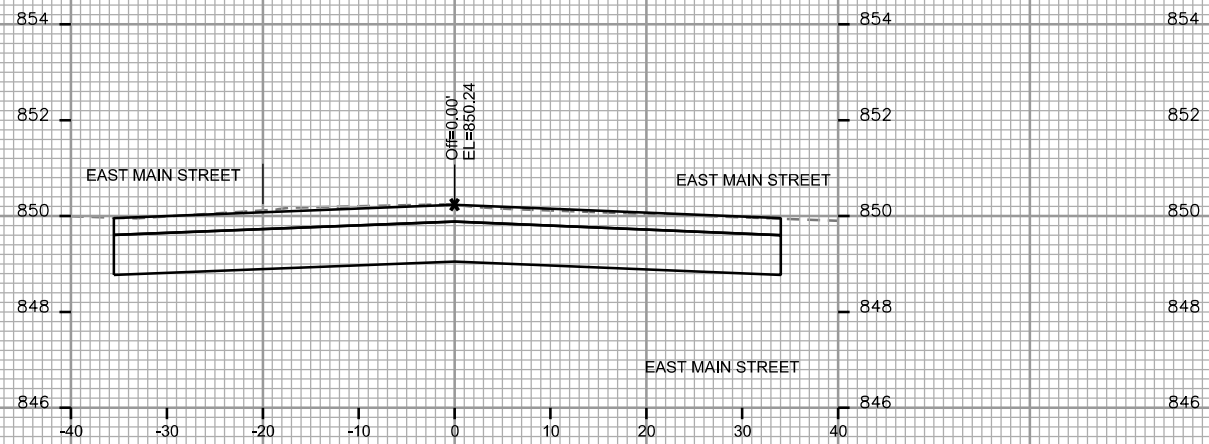

STA. 122+25

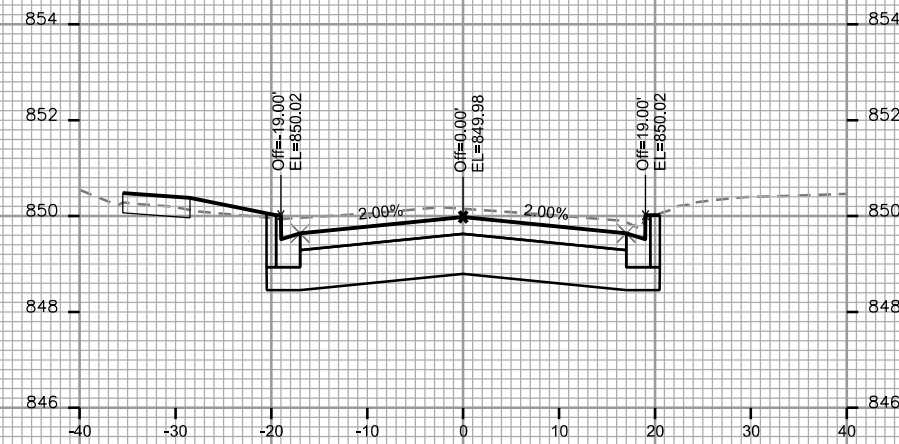

STA. 123+00

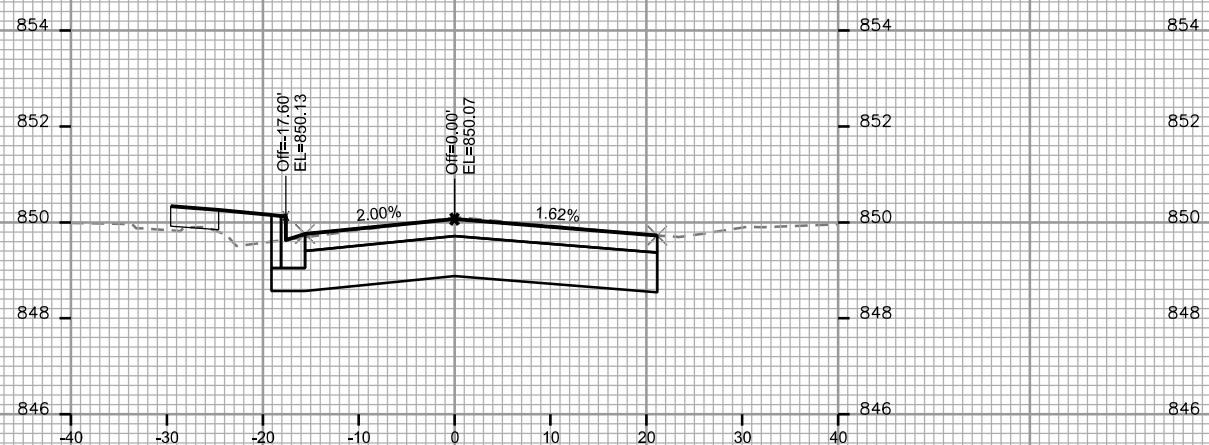

STA. 122+00

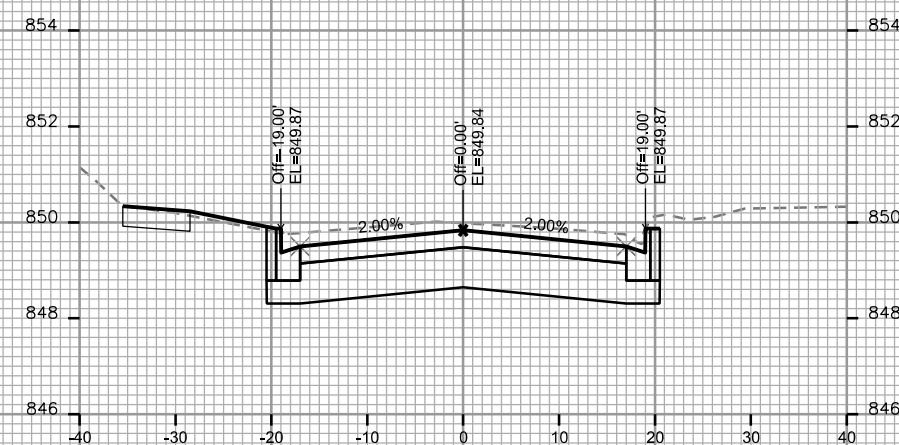

STA. 122+75

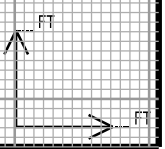

SIDEWALK SHOWN FOR
REFERENCE ONLY
INSTALLED BY OTHERS

CROSS SECTIONS

SOUTH LIVINGSTON STREET CITY OF MADISON

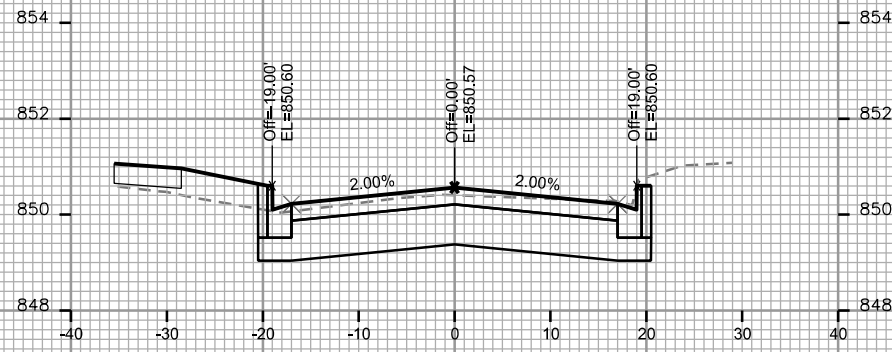

STA. 124+00

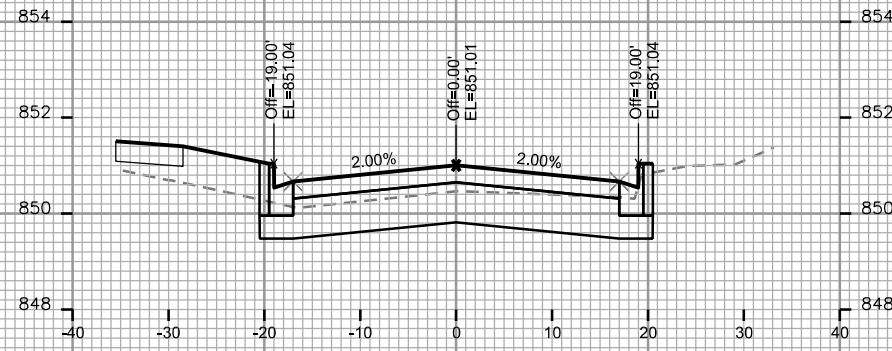

STA. 124+75

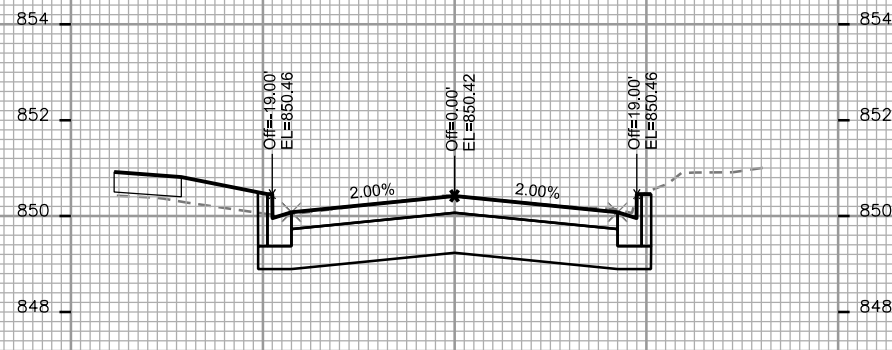

STA. 123+75

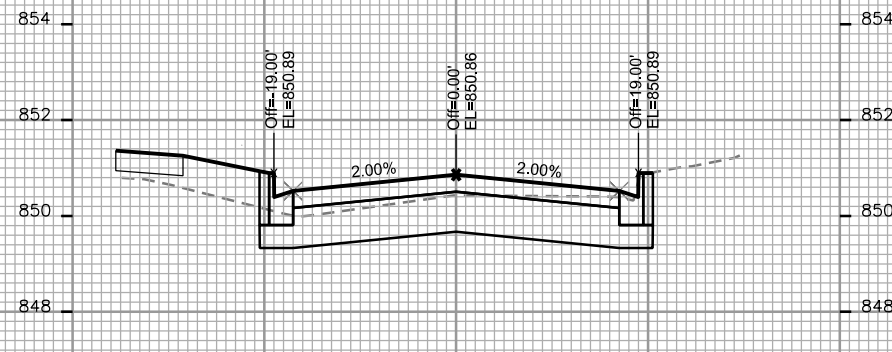

STA. 124+50

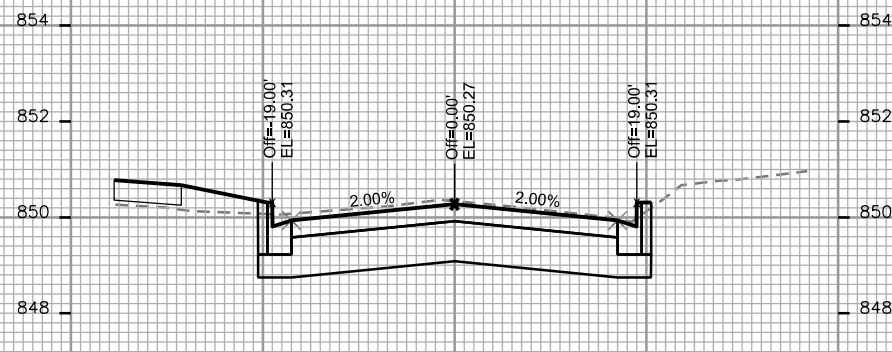

STA. 123+50

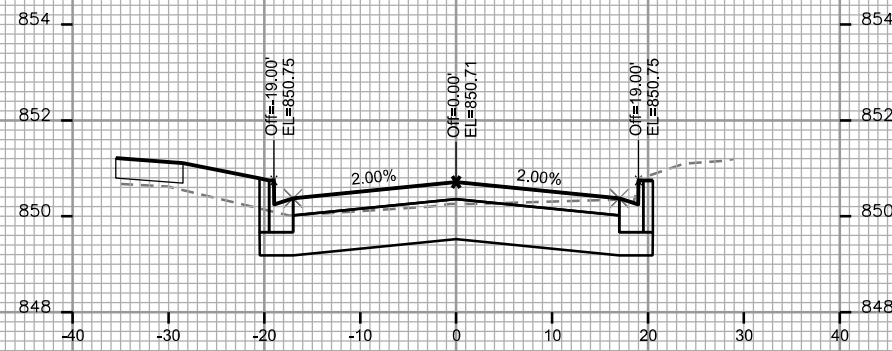

STA. 124+25

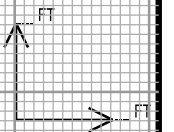

PLOT SCALE: _____

PLOT NAME: _____

REV. DATE: _____

ORIGINATOR: CITY OF MADISON - STREETS DIVISION

SIDEWALK SHOWN FOR
REFERENCE ONLY
INSTALLED BY OTHERS

PLOT SCALE: _____

PLOT NAME: _____

REV. DATE: _____

ORIGINATOR: CITY OF MADISON, STREETS DIVISION

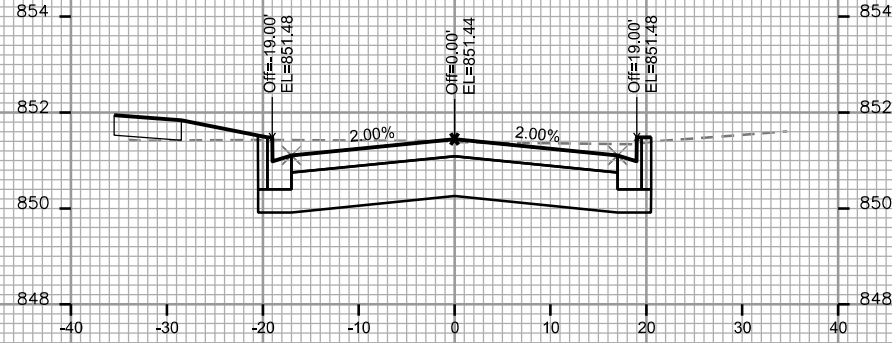

STA. 125+50

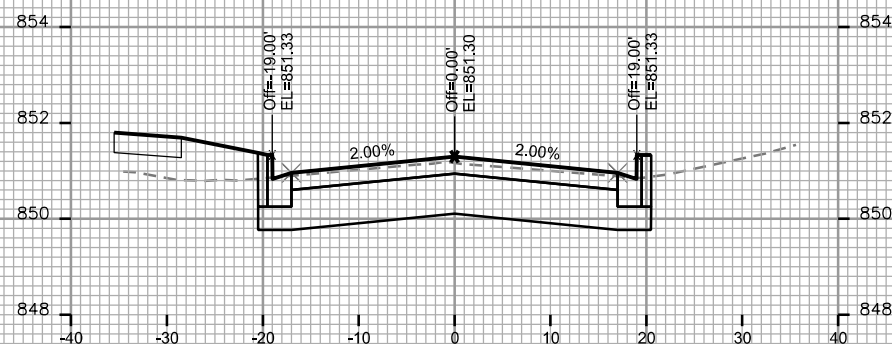

STA. 125+25

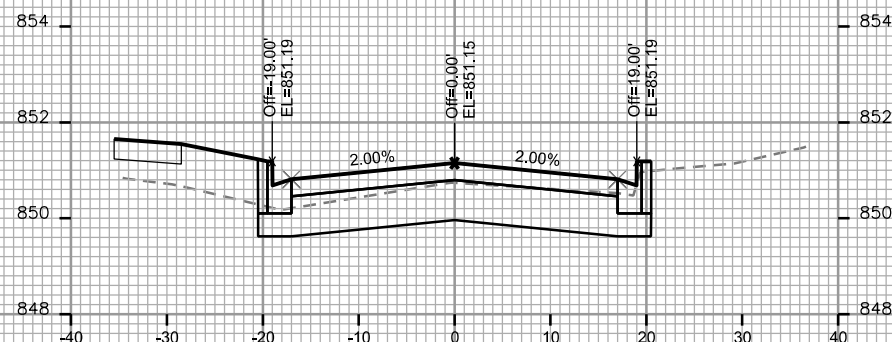

STA. 125+00

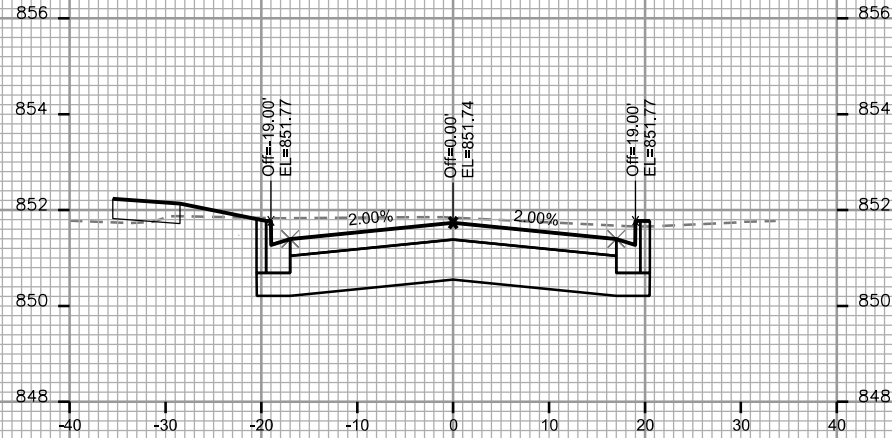

STA. 126+00

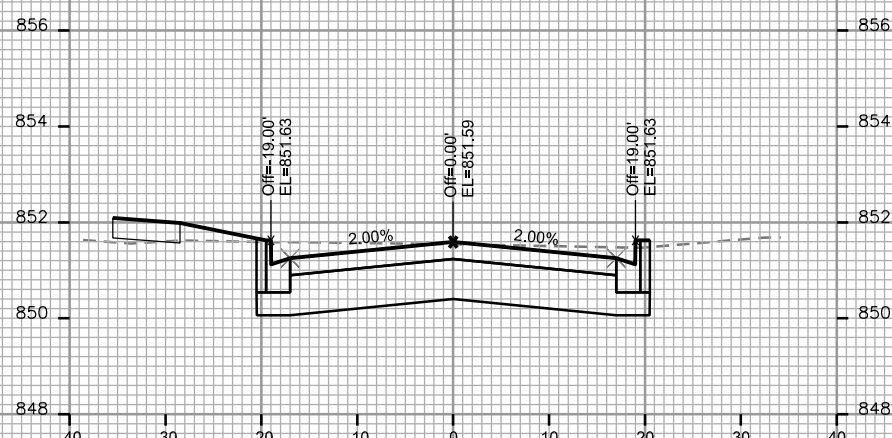

STA. 125+75

